

THREADING THE BOBBIN CASE

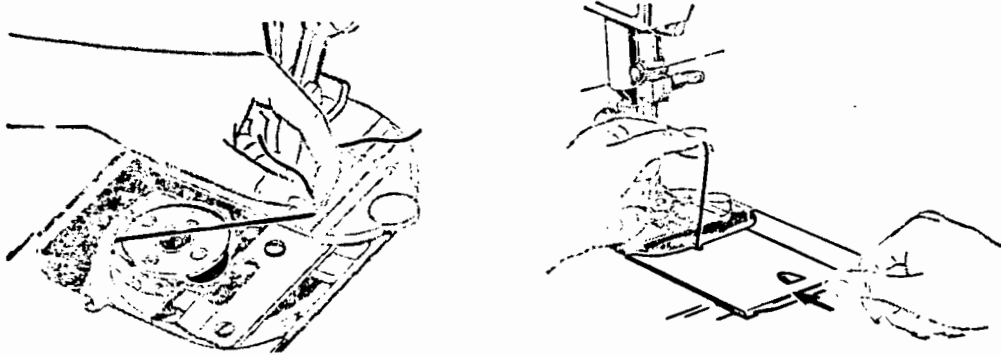

Hold bobbin so that thread leads off in direction shown. Place bobbin in case. Lead thread into slot and under spring.



Draw thread into notch at end of spring, pulling off about 3 inches of thread across the bobbin. Close slide plate allowing thread to enter notch.

15

PRINCIPAL PARTS OF MACHINE 401

